

**Grease: Metal rubber MR20 or equivalent**  
**Brake fluid: DOT 3 or DOT 4**

**CAUTION**

Do not apply grease to the thread and the seat of the sub pin.

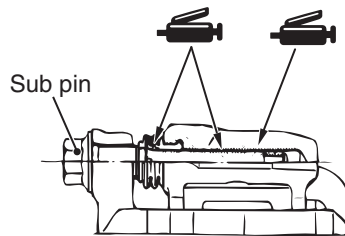

**Grease: Cosmo rubber (pin, pin boot), metal rubber MR20 (caliper body) or equivalent**

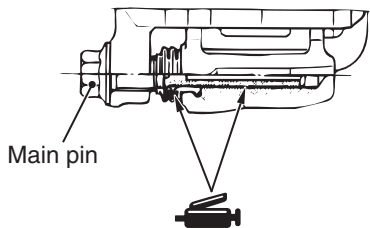
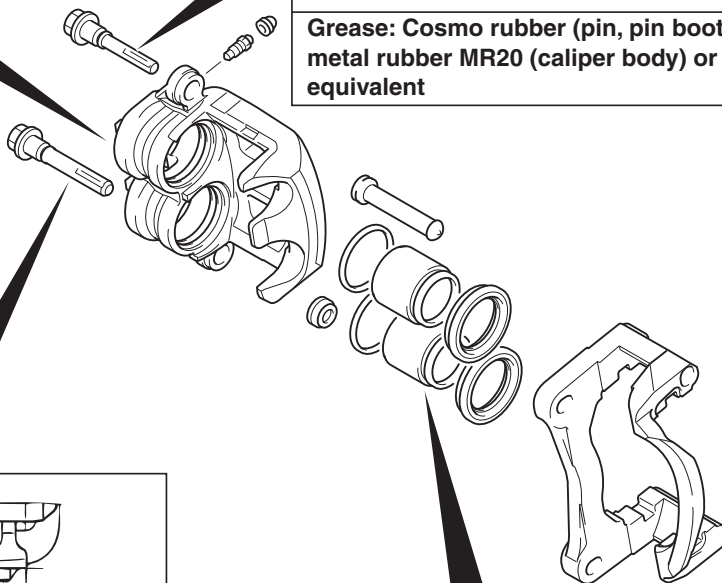

**CAUTION**

Do not apply grease to the thread and the seat of the main pin.

**Grease: Cosmo rubber grease, repair kit grease or equivalent**

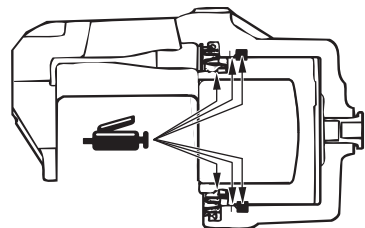

**Grease: Cosmo rubber grease, repair kit grease or equivalent (piston boot, caliper body, piston seal)**